

Godox

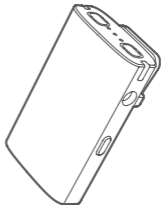

Cube-C Kit1

无线麦克风

Wireless Microphone

使用手册

Instruction Manual

前言

感谢购买神牛产品!

欢迎使用神牛无线麦克风。本产品体积小、续航长，利用 2.4GHz 波段传输音频信号。适用于直播、采访、短视频、户外拍摄等多种场景。

使用本产品之前，请仔细阅读说明书，以便正确操作及使用。

主要特点

- 全球通用频段 2.4GHz 无线技术；
- 无线距离最远可达 300 米（视距）；
- 无损音质，一键降噪；
- 小巧迷你，即插即用；
- 发射器内置锂电池，10 小时长效续航；
- 接收器支持单声道 / 立体声 / 安全音轨模式切换；
- 接收器支持直连电脑 UAC 功能，支持边充边用；
- 适用于各类品牌相机 / 手机等设备。

警告

- ⚠ 麦克风是精密设备。请勿使其掉落或受到撞击，以避免发生故障。
- ⚠ 请勿私自拆卸、改装或尝试维修本产品。产品如出现故障须由本公司或授权的维修人员进行检查维修。
- ⚠ 请保持干燥，请勿用湿手握持本产品，亦不可将产品浸入水中或暴露于雨中。
- ⚠ 请勿将本产品存放在阳光直射的地方、加热装置附近或者炎热、潮湿或多尘的地方。
- ⚠ 请勿让儿童接触本产品，以避免发生意外。
- ⚠ 请勿在易燃易爆环境中使用。在这些场合下，请注意相关警告标识。
- ⚠ 请勿放置在超过 50 度的高温环境中。
- ⚠ 请仔细阅读并遵守由厂商提供的警告或指示。
- ⚠ 如果电池更换不当会有爆炸危险，只能用同样类型或等效类型的电池来更换，仅维修人员可更换，非一般人员更换。
- ⚠ 电池不得暴露在诸如日照，火烤或类似过热环境中。
- ⚠ 消费者若使用电源适配器充电，则应购买配套使用获得 CCC 认证并满足标准要求的电源适配器。

部件名称

发射器

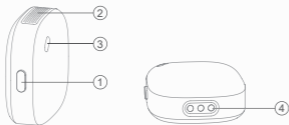

1. 电源 / 降噪 / 配对键
2. 内置麦克风
3. 指示灯
4. 磁吸充电触点

接收器 Cube-C RX

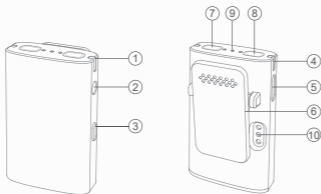

1. TX1 指示灯
2. 3.5mm 音频输出接口
3. 电源 / 配对 / 降噪按键
4. TX2 指示灯
5. USB-C 接口
6. 背夹
7. 模式 / 音量 - 键
8. 安全音轨 / 音量 + 键
9. 音量 / 安全音轨 / 模式指示灯
10. 充电触点

温馨提示：说明书中的图片均为示意图，仅供参考。由于产品不断更新与升级，产品实物与图片可能存在差异，请以实物为准。

物品清单



发射器 ×1



接收器 ×1



防风兔毛 ×1



磁吸充电线 ×1



USB-C 充电线 ×1



TRS 转 TRS 连接线 ×1



USB-C 转 USB-C
连接线 ×1



磁铁 ×2



磁吸背夹 ×1



挂绳 ×1



卡通贴纸 ×1



收纳包 ×1



说明书 ×1

发射器使用说明

开关机 / 配对 / 降噪



- 长按 2s 开关机
- 开机 30s 内双击配对
- 短按一次开启 / 关闭降噪
- 配对成功后, 在手机拍照 / 录像界面双击可遥控拍照 / 录像

注: 遥控拍照 / 录像功能需要使用 USB-C 转 USB-C 或 USB-C 转 Lightning 数据线连接手机方可使用。

充电

发射器可通过标配的磁吸充电线连接电源, 即可充电。

接收器使用说明

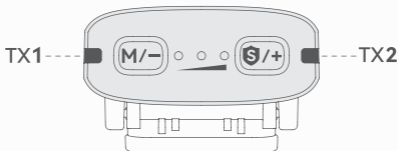

开 / 关机

长按 <  > 键 2s 可实现开 / 关机。

 绿色闪烁 → 开机未配对

注：若接收器开机后超过 5 分钟未配对成功，会自动关机。

配对

短按两次 <  > 键进入配对状态，连接成功退出配对状态，未连接成功 10s 后退出配对状态。

 绿色快闪 → 正在配对

 绿色长亮 → 配对成功

降噪

短按一次 <  > 按键开启 / 关闭降噪。

 →  橙色长亮 → 开启降噪

充电

通过 USB-C 充电线连接电源为产品充电。接收器 TX1、TX2 指示灯可以提示接收器低电量，也可提示发射器低电量。

 TX1、TX2 指示灯**红色长亮** → **接收器电量低**，请及时充电或 DC 供电

 TX1/TX2 对应指示灯**红灯闪烁**，即对应的发射器 TX1/TX2 **电量低**。

 蓝灯呼吸闪烁 → **充电中**

 蓝灯长亮 → **已充满**

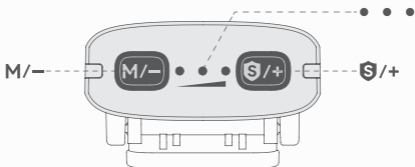

模式切换

本接收器拥有**单声道**和**立体声**两个模式，默认单声道模式。长按 < M/- > 键 2s 可切换**立体声 / 单声道**模式。

本接收器拥有安全音轨功能，安全音轨默认单声道模式，右声道以 -6dB 增益记录音频。

长按 < S/+ > 键 2s 开启**安全音轨**功能，再长按 < S/+ > 键 2s 可关闭**安全音轨**功能。

- < ●●● > 绿色长亮 → 单声道模式
- < ●●● > 蓝色长亮 → 立体声模式
- < ●●● > 绿色呼吸 → 安全音轨开启

注：只有通过 3.5mmTRS 线连接相机时可以开启立体声 / 安全音轨模式。

输出音量调节

短按 < S/+ > 键或 < M/- > 键调起音量调节状态，在 3S 内短按按钮可调节输出音量档位，共有 3 档，首次开机默认中档。

<•> 一颗灯亮起→最低档

<••> 两颗灯亮起→中间档

<•••> 三颗灯亮起→最高档

APP 下载

扫描二维码下载 Godox Mic APP, 连接成功后可利用 APP 操作使用。



注：APP 仅支持使用 USB-C 转 USB-C 数据线或 USB-C 转 Lightning 数据线连接手机状态下可用。

安装说明

发射器安装

将发射器通过磁铁吸附在衣领处，或通过磁吸背夹夹在衣领处。

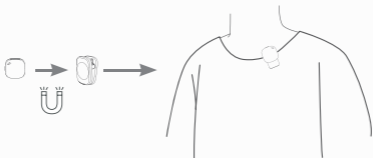
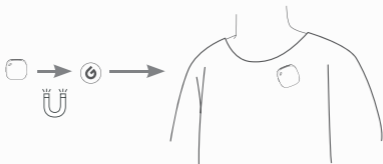

接收器安装在相机上

利用背夹，将接收器安装在相机上，通过 3.5mm TRS 转 TRS 音频线连接接收器的 3.5mm 音频输出接口与相机的 3.5mm 音频输入接口。

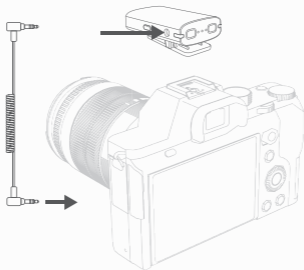

接收器安装在手机上

连接 USB-C 接口手机 (iPhone15 以上或者安卓手机)

①通过 USB-C 转 3.5mm TRS 数据线 GAC-IC9 连接接收器的 3.5mm 音频输出接口与手机的 USB-C 接口。

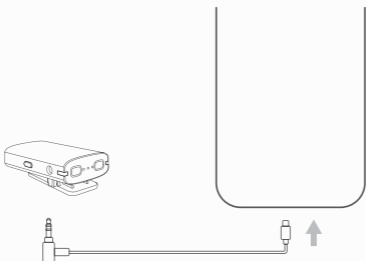

注：USB-C 转 TRS 转接线需另购。

②通过 USB-C 转 USB-C 数据线连接接收器的 USB-C 接口与手机的 USB-C 接口。

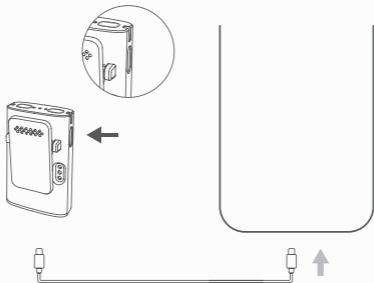

连接 Lightning 接口手机 (iPhone14 及以下型号)

①通过 Lightning 转 3.5mm TRS 数据线 GAC-IC10 连接接收器的 3.5mm 音频输出接口与手机的 Lightning 接口。

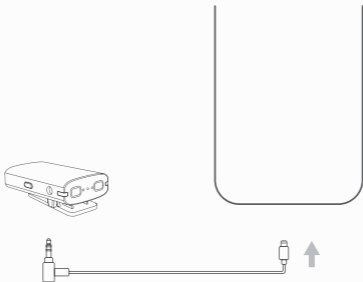

注：神牛数据线 GAC-IC10 需另购。

②通过 USB-C 转 Lightning 数据线连接接收器的 USB-C 接口与手机的 Lightning 接口。

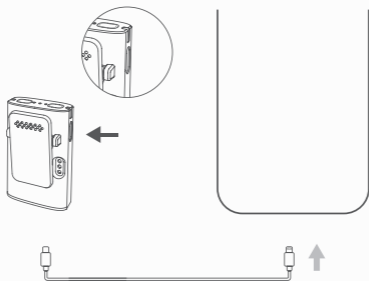

注：USB-C 转 Lightning 数据线需另购。

规格参数

名称	发射器	接收器
型号	Cube-S TX	Cube-C RX
传输类型	2.4GHz 数字跳频系统	2.4GHz 数字跳频系统
拾音模式	全向型	/
频率范围	20Hz-20KHz	/
最大 SPL	115dB	/

信噪比	> 70dB	/
最大无线距离	300 米 (视距)	300 米 (视距)
输入参数	5V — 90mA	5V = 200mA
锂电池参数	3.87V, 97mAh, 0.376Wh	3.8V, 200mAh, 0.76Wh
续航时间	约 10 小时	约 10 小时 (不开降噪)
充电时间	约 1.5 小时	约 1 小时 20 分钟
工作环境温度	-10~50°C	-10~50°C
充电温度	0°C ~45°C	0°C ~45°C
尺寸	24.5x24.8x12.5mm	46×29×18mm
净重	≈ 7g	≈ 16g

规格参数如有变更，恕不另行通知。

维护保养

避免跌落: 如果受到强烈碰撞或振动，设备可能会发生故障。

保持干燥: 本产品是非防水产品，如果将其浸入水中或放置于高湿度的环境中将可能发生故障。内部构造生锈可能会导致无法修理的损害。

避免温度骤变: 温度的突变，诸如在寒冷天进出温暖的大楼将可能会使产品内部结露。为避免结露，请将本产品事先装入手提袋或塑料包内，以防温度突变。

远离强磁场: 无线电广播发射机等设备产生的强静电或强磁场可能会干扰本产品正常工作。

如有技术更改，恕不另行通知。

Foreword

Thank you for purchasing!

Godox is proud to introduce a new wireless microphone system. With the characteristics of compact and portable, plug and play, 2.4GHz wireless transmission, as well as compatibility with various smartphones and cameras, it's quite suitable for live streaming, interview, short video recording, outdoor shooting, etc.

Please read this manual carefully before using to make sure the correct operation and exert the optimum function.

Main Features

- Globally universal 2.4GHz wireless transmission technology.
- The maximum wireless transmission distance up to 300m (sight distance).
- Clear and stable sound quality with denoise function.
- Compact and portable, plug and play.
- Built-in lithium battery in transmitter provides 10 hours of working time.
- Switchable mono, stereo and safety track modes in receiver.
- Receiver supports computer UAC function, use and charge at the same time.
- Compatible with various smartphones and cameras.

Warning

- ▲ This product is high-precision instrument, please avoid falling, collision or pounding.
- ▲ Do not disassemble. Should repairs become necessary, this product must be sent to our Company or an authorized maintenance center.
- ▲ Always keep this product dry. Do not use in rain or damp conditions.
- ▲ Do not leave or store this product in the environment of direct sunlight, near heating devices, or in hot, humid or dusty.
- ▲ Keep out of reach of children.
- ▲ Do not use in flammable and explosive environments. Pay attention to the relevant warning signs.
- ▲ Do not leave or store the product if the ambient temperature reads over 50°C .
- ▲ Please read carefully and follow the warnings or instructions provided by the manufacturer.
- ▲ If the battery is not replaced properly there is a danger of explosion, replace it only with a battery of the same type or equivalent, by service personnel only, not by general personnel.
- ▲ The battery must not be exposed to environments such as sunlight, fire, or similar excessive heat.
- ▲ Consumers who use a power adapter for charging should purchase a CCC-certified power adapter that meets the requirements of the standard.

Name of Parts

Transmitter

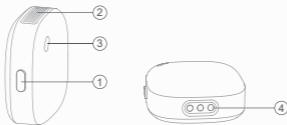

1. Power Switch/Denoise/Pairing Button
2. Built-in Microphone
3. Indicator
4. Magnetic Charging Points

Receiver Cube-C RX

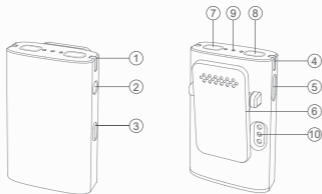

1. TX1 Indicator
2. 3.5mm Audio Output Port
3. Power Switch/Pairing/
Denoise Button
4. TX2 Indicator
5. USB-C Port
6. Back Clip
7. Mode/Volume - Button
8. Safety/ Volume + Button
9. Volume/ Safety/Mode Indicator
10. Charging Points

Note: Due to continuous updates and upgrades of the products, there may be differences between the actual products and the pictures. Therefore, the pictures are for reference only, products to prevail in kind.

What's Inside



Transmitter
×1



Receiver ×1



Furry Windscreen
×1



Magnetic Charging
Cable ×1



USB-C Charging
Cable ×1



TRS-TRS Connecting
Cable × 1



USB-C to USB-C
Connecting Cable × 1



Magnet ×2



Magnetic
Clip ×1



Portable Rope
×1



Cartoon
Stickers ×1



Storage Bag
×1



Instruction
Manual ×1

Instructions for Transmitter

Power Switch/Pair/Denoise



- Long press for 2s to turn on/off
- Double press within 30s after power on to pair
- Short press once to turn on/off denoise function
- In paired status, double press to take a picture or record when the smartphone's camera is turned on

Note: The remote photo/record function requires a USB-C to USB-C or USB-C to Lightning cable to connect to the phone.

Charging

The transmitter can be charged after connecting to power source through the attached magnetic charging cable.

Instructions for Receiver

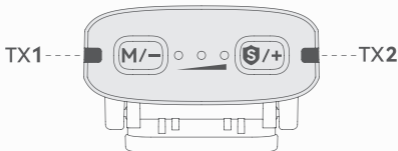

Power Switch

Long press the power switch button <  > for 2s to turn on or off the receiver.

 **Flash green** → Unpaired after powered on

Note: The receiver will be turned off if it stays unpaired in 5min after powered on.

Pairing

Short press twice the pairing button <  > to pair it with the transmitter. It will exit pairing status once paired, while exit after 10s if unpaired.

 Flash green rapidly → Pairing status

 Constant on green → Paired

Denoise

Short press the denoise button <  > to turn on or off the denoise function.

 →  Constant on orange → Denoise function is on

Charging

The receiver can be charged after connecting to power source through the USB-C charging cable. TX1 and TX2 indicators of receiver can show the battery levels of both the transmitters and receivers.

 TX1 and TX2 indicators are **constant on red** → **Battery level of receiver is low**, please charge it or switch to DC power supply

 TX1 indicator or TX2 indicator **flashes red** → **Battery level** of TX1 or TX2 transmitter is **low**

 Indicator **breathes blue** → Charging

 Indicator **is constant on blue** → Fully Charged

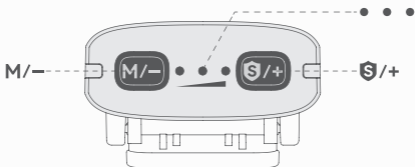

Mode Switch

The sound track mode of receiver is mono by default, long press the mode/volume – button < **M/-** > for 2s can switch to **stereo** track mode, long press again can switch back to **mono** track mode.

The safety mode is also available, which can be turned on in mono track by default, and the right channel will record the audio with -6dB gain.

Long press the safety/volume + button < **S/+** > for 2s can turn on or off the **safety** mode.

< ●●● > **Constant on green** → **Mono mode**

< ●●● > **Constant on blue** → **Stereo mode**

< ●●● > **Breathes green** → **Safety mode**

Note: The stereo and safety modes are only available when connecting the receiver with a camera by 3.5mm TRS cable.

Output Volume Adjustment

Short press the safety/volume + button <  / + > or mode/volume – button < **M** / – > to enter volume adjustment status, then short press the volume + button or volume – button in 3s can adjust the output volume in 3 levels. The volume is the middle level by default after first boot.

- < ● > **One** indicator is on → **Lowest** volume level
- < ●● > **Two** indicators are on → **Medium** volume level
- < ●●● > **Three** indicators are on → **Highest** volume level

APP Downloading

Scan the QR code to download the Godox Mic app, it can control the use of this product after connection.



Note: APP is only available when the phone is connected with USB-C to USB-C cable or USB-C to Lightning cable.

Instructions for Installation

Transmitter Installation

Absorb the transmitter to the collar with magnet, or clip it to the collar with magnetic back clip.

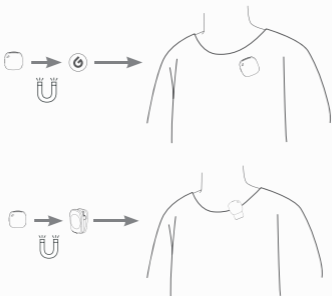

Mount the Receiver onto Cameras

Clip the receiver to the camera with its back clip, then connect the 3.5mm audio output port of receiver to the 3.5mm audio input port of camera with the 3.5mm TRS-TRS audio cable.

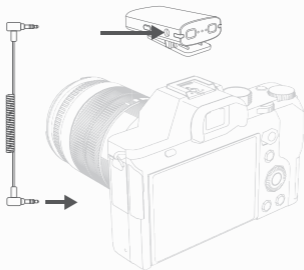

Mount the Receiver onto Smartphones

Smartphones with USB-C port (iPhone15 and thereafter or Androids)

① Connect the 3.5mm audio output port of receiver to the USB-C port of smartphone with the USB type-C to 3.5mm TRS adapter cable GAC-IC9.

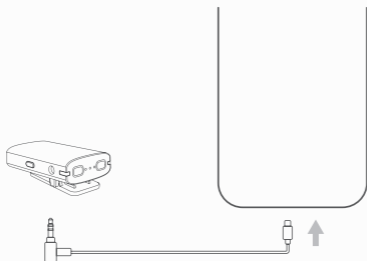

Note: USB-C to TRS adapter cable is sold separately.

② Connect the USB-C port of receiver to the USB-C port of smartphone with the USB-C to USB-C data cable.

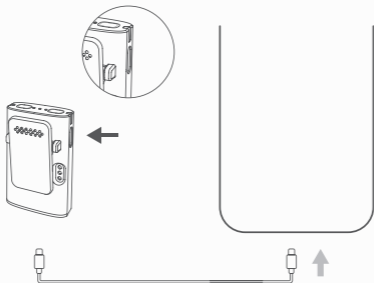

Smartphones with Lightning port (iPhone14 and therefore)

① Connect the 3.5mm audio output port of receiver to the Lightning port of smartphone with the Lightning to 3.5mm TRS adapter cable GAC-IC10.

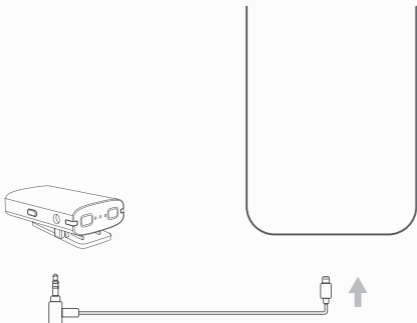

Note: GAC-IC10 is sold separately.

② Connect the USB-C port of receiver to the Lightning port of smartphone with the USB-C to Lightning data cable.

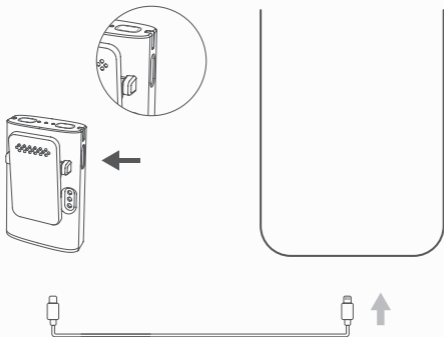

Note: USB-C to Lightning data cable is sold separately.

Technical Data

Name	Transmitter	Receiver
Model	Cube-S TX	Cube-C RX
Transmission Type	2.4GHz Frequency Hopping System	2.4GHz Frequency Hopping System
Pickup Pattern	Omnidirectional	/
Frequency	20Hz-20KHz	/
Max. SPL	115dB	/
SNR	> 70dB	/
Max. Wireless Distance	300m (sight distance)	300m (sight distance)
Input Parameters	5V = 90mA	5V = 200mA
Lithium Battery Parameters	3.87V, 97mAh, 0.376Wh	3.8V, 200mAh, 0.76Wh
Working Time	Approx. 10h	Approx. 10h (with denoise off)
Charging Time	Approx. 1.5h	Approx. 1h 20min
Working Environment	-10~50°C	-10~50°C
Charging Temperature	0°C ~45°C	0°C ~45°C
Dimension	0.96" ×0.98" ×0.49"	1.81" ×1.14" ×0.71"
Net Weight	≈ 7g	≈ 16g

Specifications and data may subject to changes without notice.

Maintenance

Avoid falling. Strong collision or vibration may malfunction the device.

Keep dry. This product is not water-proof. Malfunction, rust, and corrosion may occur and go beyond repair if soaked in water or exposed to high humidity.

Avoid sudden temperature changes. Condensation happens in sudden temperature changes such as the circumstance when taking the product out of a building with higher temperature to outside in winter. Please put the product in a handbag or plastic bag beforehand.

Keep away from strong magnetic field. The strong static or magnetic field produced by devices such as radio transmitters leads to malfunction. Specifications and data may subject to changes without notice.

Warning

Operating Frequency: 2402MHz - 2480MHz
Cube-S TX Maximum EIRP Power:-4.25dBm
Cube-C RX Maximum EIRP Power: 5dBm

Declaration of Conformity

GODOX Photo Equipment Co.,Ltd. hereby declares that this equipment are in compliance with the essential requirements and other relevant provisions of Directive 2014/53/EU. In accordance with Article 10(2) and Article 10(10), this product is allowed to be used in all EU member states.For more information of DoC, Please click this web link:

<https://www.godox.com/eu-declaration-of-conformity>

The device complies with RF specifications when the device used at 0mm from your body

FCC Statement

This device complies with part 15 of the FCC Rules. Operation is subject to the following two conditions:

- (1) This device may not cause harmful interference, and
- (2) this device must accept any interference received, including interference that may cause undesired operation. Any Changes or modifications not expressly approved by the party responsible for compliance could void the user's authority to operate the equipment.

Note: This equipment has been tested and found to comply with the limits for a Class B digital device, pursuant to part 15 of the FCC Rules. These limits are designed to provide reasonable protection against harmful interference in a residential installation. This equipment generates uses and can radiate radio frequency energy and, if not installed and used in accordance with the instructions, may cause harmful interference to radio communications. However, there is no guarantee that interference will not occur in a particular installation. If this equipment does cause harmful interference to radio or television reception, which can be determined by turning the equipment off and on, the user is encouraged to try to correct the interference by one or more of the following measures:

- Reorient or relocate the receiving antenna.
- Increase the separation between the equipment and receiver.
- Connect the equipment into an outlet on a circuit different from that to which the receiver is connected.
- Consult the dealer or an experienced radio/TV technician for help.

The device has been evaluated to meet general RF exposure requirement. The device can be used in portable exposure condition without restriction.

Marking Information

Model: Cube-S TX



R-R-gdx-018



Made in China



Li-ion Battery: 3.87V, 97mAh, 0.376Wh **FCC ID: 2ABYN120**

Input: 5V = 90mA

IC:20034-120

CAN ICES-003(B)/NMB-003(B)



® 210-234905

Model: Cube-C RX



R-R-gdx-016



Made in China



Li-ion Battery:3.8V , 200mAh,0.76Wh **FCC ID: 2ABYN132**

Input: 5 V = 200mA(Max.)

IC: 20034-132

CAN ICES-003(B)/NMB-003(B)



® 219-247155

产品保修

尊敬的用户, 本保修卡是申请保修服务的重要凭证, 请您配合销售商填写并妥善保管, 谢谢!

产品信息	型号	产品条码
用户信息	姓名	联系电话
	通信地址	
销售商信息	名称	
	联系电话	
	通信地址	
	销售日期	
备注		

注: 此表应由销售商盖章确认。

产品信息

本文件适用于相关《产品保修信息》(见后面说明)所列产品, 其他非属此范围的产品或部件(如促销品、赠品及其他出厂后附加的部件等)不在此保修承诺内。

保修期

产品及部件的相应保修期按相关的《产品保修信息》执行。保修期自产品首次购买日起算，购买日以购买产品时保修卡登记日期为准。

如何获得保修服务

您可直接与产品销售商或授权服务机构联系，也可拨打神牛产品售后服务电话，与我们联系，由我们的服务人员为您安排服务。申请保修时，您应提供有效的保修卡作为保修凭证，方可获得保修。如您不能提供有效的保修卡，则在我们确认产品或部件属于保修范围的情况下，也可以为您提供保修，但这不作为我们的义务。

不适用保修情况

如产品存在下列情况，本文件项下的保证和服务将不适用：**①产品或部件超过相应保修期；②错误或不当使用、维护或保管导致的故障或损坏，如：不当搬运；非按产品合理预期用途使用；不当插拔外接设备；跌落或外力挤压；接触或暴露于不适当温度、溶剂、酸碱、水浸或潮湿环境；③由非神牛授权机构或人员安装、修理、更改、添加或拆卸造成的故障或损坏；④产品或部件原有识别信息被修改变更或删除；⑤无有效保修卡；⑥使用非合法授权、非标准或非公开发行的软件造成的故障或损坏；⑦因不可抗力或意外事件造成的故障或损坏；⑧其他非因产品本身质量问题导致的故障或损坏。**遇上述情况，您应向相关责任方寻求解决，神牛对此不承担任何责任。因非在保修期或保修范围内的部件、附件或软件导致产品不能正常使用的，不是保修范围内的故障。产品使用过程中正常的脱色，磨损和消耗，不是保修范围内的故障。

产品保修和服务支持信息

产品的保修期和服务类型按以下《产品保修信息》执行:

产品类别	选件名称	保修期 (月)	保修服务类型
部件	主机	12	客户送修
	电池	3	客户送修
	充电器等带电性能的部件。	12	客户送修
其他	如电源线、同步线、电池盒、防风棉、防风毛罩、锁紧装置、手提绳、扎带、魔术贴、领夹、便携袋、包装等	无	无保修

神牛产品售后服务电话 0755-29609320-8062

Warranty

Dear customers, as this warranty card is an important certificate to apply for our maintenance service, please fill in the following form in coordination with the seller and safe-keep it. Thank you!

Product Information	Model	Product Code Number
Customer Information	Name	Contact Number
	Address	
Seller Information	Name	
	Contact Number	
	Address	
	Date of Sale	
Note		

Note: This form shall be sealed by the seller.

Applicable Products

Applicable Products The document applies to the products listed on the Product Maintenance Information (see below for further information). Other products or accessories (e.g. promotional items, giveaways and additional accessories attached, etc.) are not included in this warranty scope.

Warranty Period

The warranty period of products and accessories is implemented according to the relevant Product Maintenance Information. The warranty period is calculated from the day (purchase date) when the product is bought for the first time, and the purchase date is considered as the date registered on the warranty card when buying the product.

How to Get the Maintenance Service

If maintenance service is needed, you can directly contact the product distributor or authorized service institutions. You can also contact the Godox after-sale service call and we will offer you service. When applying for maintenance service, you should provide valid warranty card. If you cannot provide valid warranty card, we may offer you maintenance service once confirmed that the product or accessory is involved in the maintenance scope, but that shall not be considered as our obligation.

Inapplicable Cases

The guarantee and service offered by this document are not applicable in the following cases: ① The product or accessory has expired its warranty period; ② Breakage or damage caused by inappropriate usage, maintenance or preservation, such as improper packing, improper usage, improper plugging in/out external equipment, falling off or squeezing by external force, contacting or exposing to the improper temperature, solvent, acid, base, flooding and damp environments, etc; ③ Breakage or damage caused by non-authorized institution or staff in the process of installation, maintenance, alternation, addition and detachment; ④ The original identifying information of product or accessory is modified, alternated, or removed; ⑤ No valid warranty card; ⑥ Breakage or damage caused by using illegally authorized, nonstandard or non-public released software; ⑦ Breakage or damage caused by force majeure or accident; ⑧ Breakage

or damage that could not be attributed to the product itself. Once met these situations above, you should seek solutions from the related responsible parties and Godox assumes no responsibility. The damage caused by parts, accessories and software that beyond the warranty period or scope is not included in our maintenance scope. The normal discoloration, abrasion and consumption are not the breakage within the maintenance scope.

Maintenance and Service Support Information

The warranty period and service types of products are implemented according to the following Product Maintenance Information:

Product Type	Name	Maintenance Period(month)	Warranty Service Type
Parts	Product Main Body	12	Customer sends the product to designated site
	Battery	3	Customer sends the product to designated site
	Electrical parts e.g.battery charger, etc.	12	Customer sends the product to designated site
Other Items	Power Cable, Sync Cable, Battery Case, Windscreen Foam, Wind Cap, Locking Device, Lanyard, Tie, Velcro Tape, Clip, Bag, Package etc.	No	Without warranty